

CI Series

Intelligent SPDs

Type 1,2 (Tri-Phase AC Lines)



Specifications

- Frequency (Hz) : 50/60
- Protection Mode : L-N / N-PE
- Degree of protection : IP 20
- Diagnostics : Green LEDs (Protected) / Yellow LEDs (Check) / Red LEDs (Replace)
- Connection & Mounting Method : Parallel Connection Type / Wall Mounting
- Internal Disconnecter : Thermal Runaway Multi-Fusing Protection
- Size of connecting wir : 10 ~ 16 mm² (or # 7 ~ 5AWG)
- **Optional Functions** : **Window management program / ModBus RS485 / Ethernet Surge counter / Overvoltage counter / Real-time voltage Remote contact / Leakage current / Inside temperature Status indicator (Green -> Yellow -> Red) Power noise filter**

Model No.		SBCI+PS1-13S3P/50G	SBCI+PS1-25S3P/100G
Rated System Voltage		Tri-Phase 110~440V 4W+GND	
MCOV (Vac)		110 ~ 320	
I_n (kA) / I_{imp} (kA) -8/20 μ S- -10/350 μ S-	L-N	40 / 12.5	80 / 25
	N-PE	50 / 50	100 / 100
VPR (Vpk) (kV)	L-N	1.2	1.3
	N-PE	1.8	2.0
SCCR (kA)		200	200

Dimension

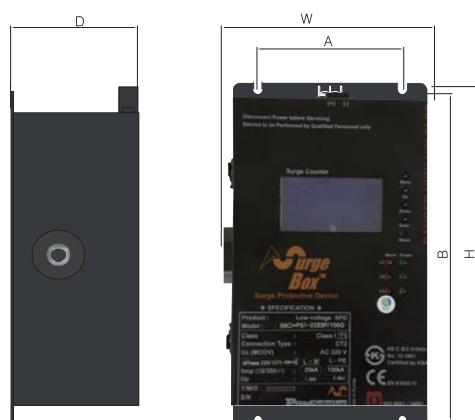

	Size (inch/mm)
W	6.88 / 175
A	4.17 / 106
B	9.44 / 240
H	9.84 / 250
D	4.37 / 111

● Circuit Diagram

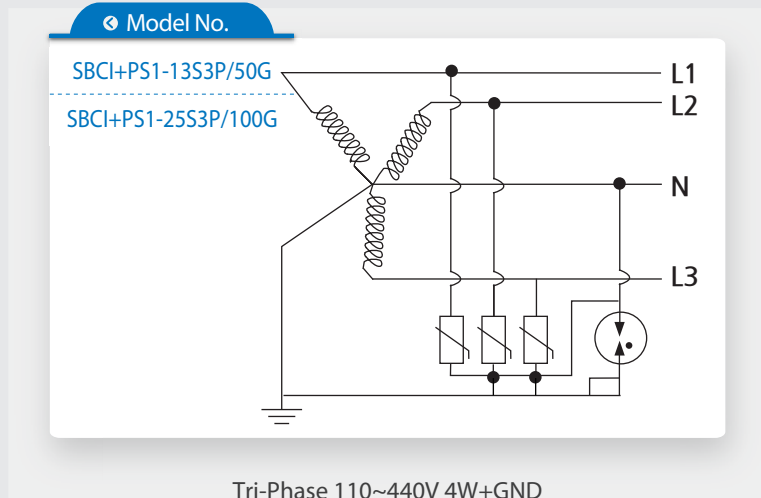

memo



HEAD OFFICE

3960 West Point Loma Blvd. Ste. H San Diego, CA 92110

John Park Director / Technical Support Dept.

Tel : +1-858,282,0901

johnpark@primepowersolutions.com

www.PrimePowerSolutions.com